

Liverpool Office  
Unit 3, Weaver Industrial Estate,  
Blackburne Street, Garston,  
Liverpool, L19 8JA  
Tel: 0151 494 1188  
www.premier-traffic.co.uk

23 August 2023

DRAWING No. P6155 - B

Drawn By:	Revision No:	Comments
Shauna Ovenshaw		
Checked By:		
S Robinson		
Approved By:		
S Robinson		

Project: Road Closure Diversion

CLIENT: HIP & HARMONY CIC

Address: High Street  
Neston

SCALE: 1:500 @ A3

Key:

	Works Area
	Pedestrian barrier
	Traffic Cones
	Traffic light head
	Sign
	Pedestrian route

This Drawing is the property of Premier Traffic Management Ltd. It is not to be used for any other project without written permission.

DO NOT SCALE FROM THIS DRAWING

**TMCA** TRAFFIC MANAGEMENT CONTRACTORS ASSOCIATION

**NHSS** NATIONAL HIGHWAYS SERVICE

**QAV** QUALITY ASSURED VENDOR

**Chapter 8 Details**

DETAIL A (A) Presented sign to Diagram 810 above and behind cones

Running lane(s) Three only, date spaced 750mm or 1m high traffic cones

Head Three only, date spaced 750mm or 1m high traffic cones

Shoulder Three only, date spaced 750mm or 1m high traffic cones

Notes: 1) During darkness, a single warning light to BS EN 12352:2006 should be provided in accordance with Table A1.3 (Appendix 1) and to BS EN 13422. 2) Traffic cones should conform to diagram 7101.1 and to BS EN 13422.

DETAIL B (B) Single/Dual carriageway 40mph or less - 450mm traffic cones, spacing 1.5m. Single/Dual carriageway 50mph or more - 750mm traffic cones, spacing 1.5m, relaxation 3m.

Notes: 1) During darkness, warning lights to BS EN 12352:2006 should be provided in accordance with Table A1.3 (Appendix 1) and to BS EN 13422. 2) For relaxation to Detail C1 see Table A1.3 (Appendix 1).

DETAIL C1 (C) Single/Dual carriageway 40mph or less - 450mm traffic cones, spacing 1.5m. Single/Dual carriageway 50mph or more - 750mm traffic cones, spacing 1.5m, relaxation 3m.

Notes: 1) During darkness, warning lights to BS EN 12352:2006 should be provided in accordance with Table A1.3 (Appendix 1) and to BS EN 13422. 2) Detail (D) applies only to relaxation cases.

DETAIL D (D) Single/Dual carriageway 40mph or less - 450mm traffic cones, spacing 1.5m. Single/Dual carriageway 50mph or more - 750mm traffic cones, spacing 1.5m, relaxation 3m.

Notes: 1) During darkness, warning lights to BS EN 12352:2006 should be provided in accordance with Table A1.3 (Appendix 1) and to BS EN 13422. 2) Detail (D) applies only to relaxation cases.

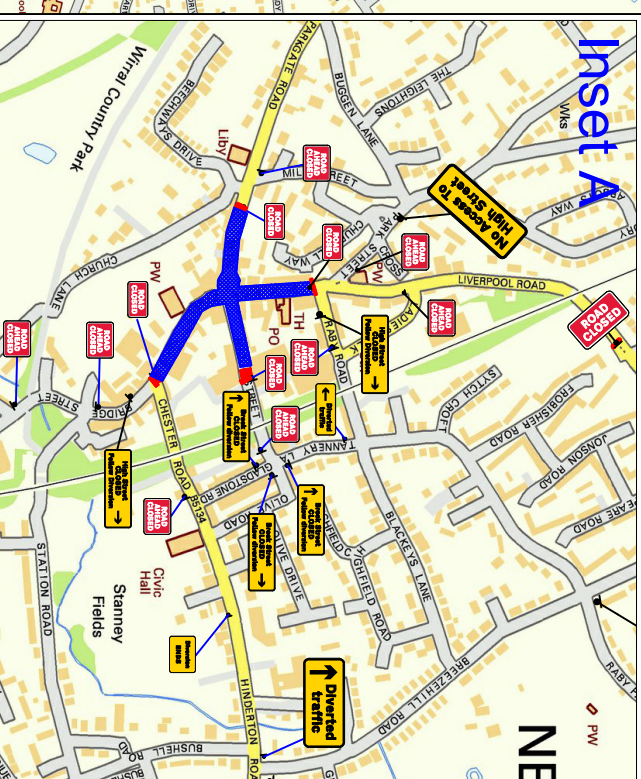
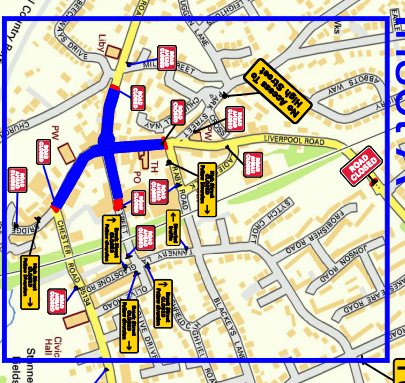
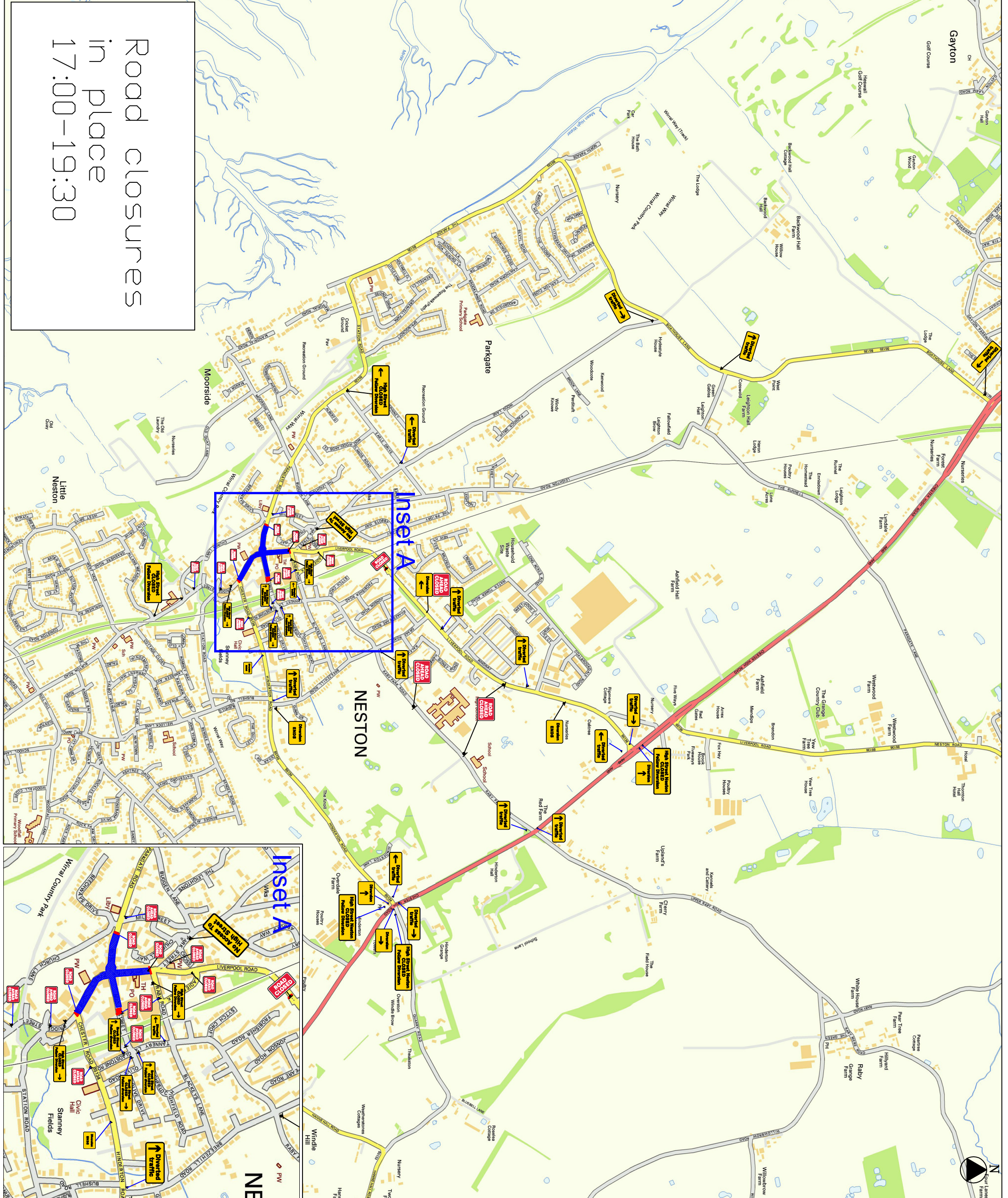

Road closures  
in place  
17:00-19:30